

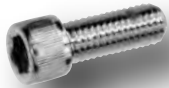

Bulk Chrome Fasteners Metric

Allen Screws Chrome Plated and Polished



For Metric Chrome Allen
with Knurls
use 12xxx



For Polished Chrome Allen
with Knurls Removed
use 10xxx

	4mm/ 0.7	5mm/ 0.8	6mm/ 1.0	8mm/ 1.25	8mm/ 1.0 <small>Fine Thread</small>	10mm/ 1.50 <small>Fine Thread</small>	10mm/ 1.25 <small>Fine Thread</small>	12mm/ 1.75
8		12721	12734					
10	12711	12722	12735	12770				
12	12712	12723	12736	12771				
16	12714	12725	12738	12772				
20	12715	12726	12739	12773	12773F	12794	12816	
25	12716	12727	12740	12774	12774F	12795	12817	12836
27			12740A		12775F			
30	12717	12728	12741	12775	12776F	12796	12818	12837
35		12729	12742	12776	12777F	12797	12819	12838
40		12730	12743	12777	12778F	12798	12820	12839
45		12731	12744	12778	12779F	12799	12821	12840
50		12732	12745	12779		12800	12822	12841
55			12746	12780		12801	12823	12842
60		12733	12747	12781		12802	12824	12843
65			12748	12782		12803	12825	12844
70			12749	12783		12804	12826	12845
75			12750	12784		12805	12827	12846
80			12751	12785		12806	12828	12847
85				12786		12807	12829	12848
90			12753	12787		12808	12830	12849
95			12754					
100			12755	12788		12809	12831	12850
110			12756	12789		12810		
115			12756A					
120			12757	12790		12811		

Key: Read Across For Diameter
Read Down For Length

Call if you do not see
the sizes you need !

Button Head Allen Screws



	4mm/ 0.7	5mm/ 0.8	6mm/ 1.0	8mm/ 1.25	10mm/ 1.50	12mm/ 1.75
6	13709					
8	13710	13721	13734			
10	13711	13722	13735	13770		
12	13712	13723	13736	13771		
16	13714	13725	13738	13772	13793	
20	13715	13726	13739	13773	13794	13835
25	13716	13727	13740	13774	13795	
30		13728	13741	13775	13796	13837
35			13742	13776	13797	13838
40	13719		13743	13777	13798	13839
45				13778	13799	
50				13779	13800	13841
60				13781	13802	13843
70				13783	13804	13845
80				13785	13806	
90				13787	13808	13849
100						13850

Flat Head Allen Screws



	4mm/ 0.7	5mm/ 0.8	6mm/ 1.0	8mm/ 1.25	10mm/ 1.50
6	14709				
8	14710	14721	14734		
10	14711	14722	14735		
12	14712	14723	14736	14771	
16	14714	14725	14738	14772	14793
20	14715	14726	14739	14773	14794
25	14716	14727	14740	14774	14795
30	14717	14728	14741	14775	14796
35	14718	14729	14742	14776	14797
40	14719	14730	14743	14777	14798
45	14720A	17731	17744	14778	14799



**Metric
Bulk Chrome**

Hex Cap Screws Chrome Plated

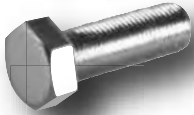

	4mm/ 0.7	5mm/ 0.8	6mm/ 1.0	7mm/ 1.0	8mm/ 1.25	Fine Thread 8mm/ 1.0	10mm/ 1.50	Fine Thread 10mm/ 1.25	Fine Thread 10mm/ 1.00	12mm/ 1.75	Fine Thread 12mm/ 1.50	14mm/ 2.00	14mm/ 1.50
10	11711	11722	11735	11760	11770	11770F							
16	11712	11725	11738	11762	11772	11772F	11793						
20	11714	11726	11739	11763	11773	11773F	11794	11816	11816F	11835	11856	11873	
25	11715	11727	11740	11764	11774	11774F	11795	11817	11817F	11836	11857	11874	11895
30	11716	11728	11741	11765	11775	11775F	11796	11818	11818F	11837	11858	11875	
35	11717	11729	11742	11766	11776	11776F	11797	11819	11819F	11838	11859	11876	
40		11730	11743	11767	11777	11777F	11798	11820	11820F	11839	11860	11877	
45		11731	11744		11778	11778F	11799	11821	11821F	11840	11861		11899
50		11732	11745	11769	11779	11779F	11800	11822	11822F	11841	11862	11879	
55			11746		11780	11780F	11801	11823	11823F	11842	11863		11901
60			11747		11781	11781F	11802	11824	11824F	11843	11864	11881	
65			11748		11782	11782F	11803	11825	11825F	11844	11865		
70			11749		11783	11783F	11804	11826	11826F	11845	11866	11883	
75			11750		11784	11784F	11805			11846	11867		
80			11751		11785	11785F	11806	11828	11828F	11847	11868	11885	
90			11753		11787	11787F	11808	11830	11830F	11849	11870	11887	
100			11755		11788	11788F	11809	11831	11831F	11850	11871	11888	
110			11756		11789	11789F	11810			11851			
120			11757		11790	11790F	11811			11852			
130										11853		11891	
140					11792	11792F	11813					11892	

12 Point Flange



**Key: Read Across For Diameter
Read Down For Length**

*Call if you do not see
the sizes you need !*

	6mm/ 1.0	8mm/ 1.25	10mm/ 1.50	12mm/ 1.75
16	29738	29772		
20	29739	29773		
25	29740	29774	29795	29836
30	29741	29775	29796	29837
35	29742	29776	29797	29838
40	29743	29777	29798	29839
45	29744	29778	29799	29840
50	29745	29779	29800	29841
55		29780	29801	29842
60		29781	29802	29843
65		29782	29803	
70		29783	29804	
75		29784		
80		29785	29806	
90			29807	29849
100			29808	29850
110				
120				



Demand only the finest Quality Fasteners



Bulk Chrome Fasteners Metric

Nuts Chrome Plated

Acorn Nuts	
Size	Part #
4mm x .70	21950
5mm x .80	21952
6mm x 1.0	21954
7mm x 1.0	21956
8mm x 1.0	
8mm x 1.25	21958
10mm x 1.25	21961
10mm x 1.50	21962
12mm x 1.25	21963
12mm x 1.50	21965
12mm x 1.75	21966



Hex Nuts	
Size	Part #
4mm x .70	15950
5mm x .80	15952
6mm x 1.0	15954
7mm x 1.0	15956
8mm x 1.0	15957
8mm x 1.25	15958
10mm x 1.25	15961
10mm x 1.50	15962
12mm x 1.25	15963
12mm x 1.50	15965
12mm x 1.75	15966
14mm x 1.50	15967
14mm x 2.00	15968
16mm x 1.50	15969
16mm x 2.00	15970



Jam Nuts	
Size	Part #
8mm x 1.0	16957
8mm x 1.25	16958
10mm x 1.25	16961
10mm x 1.50	16962
12mm x 1.25	16963
12mm x 1.50	16965
12mm x 1.75	16966
14mm x 1.50	16967
14mm x 2.00	16968
16mm x 1.50	16969
16mm x 2.00	16970



Nylon Insert Lock Nuts	
Size	Part #
4mm x .70	17950
5mm x .80	17952
6mm x 1.0	17954
7mm x 1.0	17956
8mm x 1.0	17957
8mm x 1.25	17958
10mm x 1.25	17961
10mm x 1.50	17962
12mm x 1.25	17963
12mm x 1.50	17965
12mm x 1.75	17966
14mm x 1.50	17967
14mm x 2.00	17968
16mm x 1.50	17969
16mm x 2.00	17970



Flange Nuts

Size	Part #
6mm x 1.0	44954
8mm x 1.25	44958
10mm x 1.50	44962
12mm x 1.75	44966
16mm x 2.0	44970



Flange Lock Nuts

Size	Part #
8mm x 1.25	44958-L
10mm x 1.50	44962-L
12mm x 1.75	44966-L
16mm x 2.0	44970-L



Washers Chrome Plated

Flat Washers	
Size	Part #
4mm	23985
5mm	23986
6mm	23987
7mm	23988
8mm	23989
10mm	23990
12mm	23991
14mm	23992
16mm	23993



Lock Washers	
Size	Part #
4mm	24985
5mm	24986
6mm	24987
7mm	24988
8mm	24989
10mm	24990
12mm	24991
14mm	24992
16mm	24993



Wave Washers	
Size	Part #
8mm	23989W
12mm	24991W



Super Flat Washers

Size	Part #
6mm x 10	23735
6mm x 18	23278A
8mm x 24	23773A

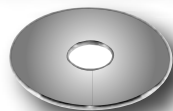

Note: See specification for dimensions
Page 118