



## Allen Screws Stainless Steel



**73xxx for Stainless Steel  
Allens with Knurls or for  
Polished add SP-73xxx**

	4mm/ 0.7	5mm/ 0.8	6mm/ 1.0	8mm/ 1.25	10mm/ 1.50	12mm/ 1.75
8		73721	73734			
10	73711	73722	73735	73770		
12	73712	73723	73736	73771		
16	73714	73725	73738	73772		
20	73715	73726	73739	73773	73794	73835
25	73716	73727	73740	73774	73795	73836
30	73717	73728	73741	73775	73796	73837
35		73729	73742	73776	73797	73838
40		73730	73743	73777	73798	73839
45		73731	73744	73778	73799	73840
50		73732	73745	73779	73800	73841
55			73746	73780	73801	73842
60			73747	73781	73802	73843
65			73748	73782	73803	73844
70			73749	73783	73804	73845
75			73750	73784	73805	73846
80			73751	73785	73806	73847
90			73753	73787	73808	73849
100				73788	73809	73850

## Button Head Allen Screws



**72xxx for Stainless Steel  
Allen Button Heads or for  
Polished add SP-72xxx**

	4mm/ 0.7	5mm/ 0.8	6mm/ 1.0	8mm/ 1.25	10mm/ 1.50
8	72710	72721	72734		
10	72711	72722	72735	72770	
12	72712	72723	72736	72771	
16	72714	72725	72738	72772	72793
20		72726	72739	72773	72794
25		72727	72740	72774	72795
30		72728	72741	72775	72796

## Flat Head Allen Screws



**71xxx for Stainless Steel  
Flat Head Allens or for  
Polished add SP-71xxx**

	4mm/ 0.7	5mm/ 0.8	6mm/ 1.0	8mm/ 1.25	10mm/ 1.50
6	71709				
8	71710	71721	71734		
10	71711	71722	71735		
12	71712	71723	71736	71771	
16	71714	71725	71738	71772	71793
20	71715	71726	71739	71773	71794
25	71716	71727	71740	71774	71795
30	71717	71728	71741	71775	71796

## Hex Caps Screws

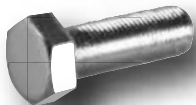

**77xxx for Stainless Steel  
Hex Caps or for Polished  
add SP-77xxx**

	4mm/ 0.7	5mm/ 0.8	6mm/ 1.0	8mm/ 1.25	10mm/ 1.50	12mm/ 1.75
10	77711	77722	77735	77770		
16	77714	77725	77738	77772	77793	
20	77715	77726	77739	77773	77794	77835
25	77716	77727	77740	77774	77795	77836
30	77717	77728	77741	77775	77796	77837
35		77729	77742	77776	77797	77838
40		77730	77743	77777	77798	77839
45		77731	77744	77778	77799	77840
50		77732	77745	77779	77800	77841
55			77746	77780	77801	77842
60			77747	77781	77802	77843
65			77748	77782	77803	77844
70			77749	77783	77804	77845
75			77750	77784	77805	77846
80			77751	77785	77806	77847
90			77753	77787	77808	77849
100			77755	77788	77809	77850
110			77756	77789	77810	77851

## Carriage Bolts



**79xxx for Stainless Steel  
Carriage Bolts or for  
Polished add SP-79xxx**

	10mm/ 1.50
25	79795
50	79800
60	79802

**Key: Read Across For Diameter  
Read Down For Length**

**Call if you do not see  
the sizes you need !**



## Washers Stainless Steel

### Flat Washers

Size	Part #
4mm	75985
5mm	75986
6mm	75987
8mm	75989
10mm	75990
12mm	75991
14mm	75992
16mm	75993



### Lock Washers

Size	Part #
4mm	76985
5mm	76986
6mm	76987
8mm	76989
10mm	76990
12mm	76991
14mm	76992
16mm	76993



### Wave Washers

Size	Part #
5mm	76986W
6mm	76987W
8mm	76989W
10mm	76990W



## Chart #1: Select Styles

**Example:** To order a 6 x 10 Oval Phillips Machine Screw: Use **Chart #1** for head style part number which would be "89". Look up diameter and length from **Chart #2** for last three digits 6 x 10 is 735. Put the two together for a part number of 89735, or simply order by style and size. **Include the Prefix SP-89735 for Stainless Steel Polished**



Cheesehead

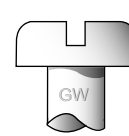

Pan



Oval

## Nuts Stainless Steel

### Hex Nuts

Size	Part #
4mm x .70	70950
5mm x .80	70952
6mm x 1.0	70954
7mm x 1.0	70956
8mm x 1.25	70958
10mm x 1.0	70959
10mm x 1.25	70961
10mm x 1.50	70962
12mm x 1.50	70965
12mm x 1.75	70966



### Jam Nuts

Size	Part #
8mm x 1.25	67958
10mm x 1.50	67962
12mm x 1.75	67966



*For Stainless Steel Polished order with the Prefix than five digit Part # SP-xxxxx*

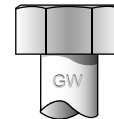

Hex



Flat

## Chart #1: Select Styles

Style	Slotted	Phillips
Round Head	99	N/A
Flat Head	98	94
Truss Head	93	N/A
Oval Head	97	89
Pan Head	96	92
Cheesehead	78	N/A
Hex	77	N/A

## Nylon Inserts

Size	Part #
4mm x .70	69950
5mm x .80	69952
6mm x 1.0	69954
8mm x 1.25	69958
10mm x 1.50	69962
12mm x 1.75	69966



All Items shown on this page can be purchased individually

## Chart #2: Metric Machine Screws

	m3	m4	m5	m6	m8
8mm	701	710	721	734	770
10mm	702	711	722	735	771
12mm	703	712	723	736	772
16mm	705	714	725	738	773
29mm	706	715	726	739	774
25mm	707	716	727	740	775
30mm	708	717	728	741	776
35mm				742	777