



Bulk Zinc Fasteners American

Allen Screws Zinc Plated



08xxx
for Allen Screws
with Knurls

	4/40	6/32	8/32	10/24	10/32	1/4 -20	1/4 -28	5/16 -18	5/16 -24	3/8 -16	3/8 -24	7/16 -14	7/16 -20	1/2 -13	1/2 -20
3/8	08088	08104	08128	08152	08153	08204									
1/2	08089	08106	08130	08154	08155	08206	08207	08270	08271	08322	08323				
5/8			08132	08156	08157	08208	08209	08272	08273	08324	08325				
3/4	08091	08110	08134	08158	08159	08210	08211	08274	08275	08326	08327	08374	08375	08414	08415
7/8			08136	08160	08161	08212	08213	08278	08279	08328					
1		08114	08138	08162	08163	08214	08215	08280	08281	08330	08331	08376	08377	08416	08417
1 1/4			08140	08166	08167	08218	08219	08284	08285	08334	08335	08378		08418	08419
1 1/2			08142	08168	08169	08220	08221	08286	08287	08336	08337	08380		08420	08421
1 3/4				08170	08171	08222	08223	08288	08289	08338	08339	08382		08422	08423
2				08172	08173	08224	08225	08290	08291	08340	08341	08384		08424	08425
2 1/4						08226	08227	08292	08293	08342		08386		08426	
2 1/2						08228	08229	08294	08295	08344		08388		08428	
2 3/4						08230		08296		08346				08430	
3						08232		08298		08348				08432	
3 1/4										08350					
3 1/2						08236				08352					
4						08240									
4 1/2						08244									

Hex Cap Screws Zinc Plated and L-9 Products

	1/4 -20	1/4 -28	5/16 -18	5/16 -24	3/8 -16	3/8 -24	7/16 -14	7/16 -20	1/2 -13	1/2 -20	5/8 -11	5/8 -18
1/2	07206	07207	07270	07271	07322	07323						
5/8	07208	07209	07272	07273	07324	07325						
3/4	07210	07211	07274	07275	07326	07327	07374	07375	07414			
7/8	07212	07213	07278	07279	07328	07329						
1	07214	07215	07280	07281	07330	07331	07376	07377	07416	07417	07488	07489
1 1/4	07218	07219	07284	07285	07334	07335	07378	07379	07418	07419	07490	07491
1 1/2	07220	07221	07286	07287	07336	07337	07380	07381	07420	07421	07492	07493
1 3/4	07222	07223	07288	07289	07338	07339	07382	07383	07422	07423	07494	07495
2	07224	07225	07290	07291	07340	07341	07384	07385	07424	07425	07496	07497
2 1/4	07226	07227	07292	07293	07342	07343	07386	07387	07426	07427	07498	07499
2 1/2	07228	07229	07294	07295	07344	07345	07388	07389	07428	07429	07500	07501
2 3/4	07230	07231	07296	07297	07346	07347	07390	07391	07430	07431	07502	07503
3	07232	07233	07298	07299	07348	07349	07392	07393	07432	07433	07504	07505
3 1/4	07234	07235	07300	07301	07350	07351	07394	07395	07434	07435	07506	07507
3 1/2	07236	07237	07302	07303	07352	07353	07396	07397	07436	07437	07508	07509
4	07240	07241	07306	07307	07356	07357	07400	07401	07440	07441	07512	07513
4 1/2	07244		07310	07311	07360	07361	07404	07405	07442	07443	07514	07515
5	07246		07312	07313	07362	07363	07406	07407	07444	07445	07516	07517
5 1/2			07316	07317	07366	07367	07410	07411	07446	07447	07518	07519
6				07319	07368		07412		07448	07449	07520	07521

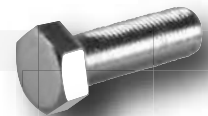

07xxx
for Zinc Hex Cap

NOTE:
Some sizes may
not be available
in L-9 Zinc,
Please call.

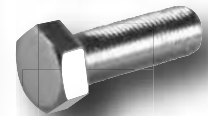

When Ordering
L-9 Zinc Plated
Hex Caps
use 52xxx
for the first two
numbers in Part #



American Bulk Zinc

Washers Zinc Plated and L-9 Products

Flat Washers and L-9

Size	Part #	L-9 #
4	04564	--
6	04565	--
8	04566	--
10	04567	--
12	04568	--
1/4	04569	55569
5/16	04570	55570
3/8	04571	55571
7/16	04572	55572
1/2	04573	55573
9/16	04574	55574
5/8	04575	55575
3/4	04576	--
7/8	04577	--



Fender Washers

Size	Part #
10 x 1	01567
1/4 x 1	01569
1/4 x 1 1/4	01218
1/4 x 1 1/2	09569
5/16 x 1 1/4	01284
5/16 x 1 1/2	01570
3/8 x 1 1/2	01571

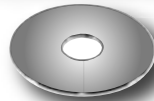

External Lock Washers

Size	Part #
4	02564
6	02565
8	02566
10	02567
12	02568
1/4	02569
5/16	02570
3/8	02571
7/16	02572
1/2	02573



Internal Lock Washers

Size	Part #
4	03564
6	03565
8	03566
10	03567
12	03568
1/4	03569
5/16	03570
3/8	03571
7/16	03572
1/2	03573
5/8	03575
3/4	03576



Lock Washers and L-9

Size	Part #	L-9 #
4	05564	--
6	05565	--
8	05566	--
10	05567	--
12	05568	--
1/4	05569	52569
5/16	05570	52570
3/8	05571	52571
7/16	05572	52572
1/2	05573	52573
9/16	05574	52574
5/8	05575	52575
3/4	05576	--
7/8	05577	--
1	05578	--



Nuts Zinc Plated and L-9 Products

Hex Nuts & L-9

Size	Part #	L-9 #
4/40	06536	--
5/40	06537	--
6/32	06538	--
8/32	06540	--
10/24	06542	--
10/32	06543	--
1/4-20	06546	52546
1/4-28	06547	52547
5/16-18	06548	52548
5/16-24	06549	52549
3/8-16	06550	52550
3/8-24	06551	52551
7/16-14	06552	52552
7/16-20	06553	52553
1/2-13	06554	52554
1/2-20	06555	52555
9/16-12	06556	06556
9/16-18	06557	--
5/8-11	06558	52558
5/8-18	06559	52559
3/4-10	06560	--
3/4-16	06561	--



Nylon Lock Nuts

Size	Part #
4/40	03536
5/40	03537
6/32	03538
8/32	03540
10/24	03542
10/32	03543
1/4-20	03546
1/4-28	03547
5/16-18	03548
5/16-24	03549
3/8-16	03550
3/8-24	03551
7/16-14	03552
7/16-20	03553
1/2-13	03554
1/2-20	03555
9/16-12	03556
9/16-18	03557
5/8-11	03558
5/8-18	03559
3/4-10	03560
3/4-16	03561



Jam Hex Nuts

Size	Part #
1/4-20	04546
1/4-28	04547
5/16-18	04548
5/16-24	04549
3/8-16	04550
3/8-24	04551
7/16-14	04552
1/2-20	04555
9/16-18	04557
5/8-18	04559
3/4-16	04561



Jam Lock Nuts

Size	Part #
1/4-20	02546
1/4-28	02547
5/16-18	02548
5/16-24	02549
3/8-16	02550
3/8-24	02551
7/16-14	02552
7/16-20	02553
1/2-13	02554
1/2-20	02555
9/16-12	02556
9/16-18	02557
5/8-11	02558
5/8-18	02559



All items shown on this page can be purchased individually



Bulk Zinc Fasteners American

Machine and Sheet Metal Screws Zinc Plated

Example: To order a **8/32 x 5/8 Oval Phillips Machine Screw**: Use **Chart #1** for the type of head style required, take those first two digits for the beginning part number which would be **"40"**. Now look up the diameter and length from **Chart #2 or #3** for last three digits for **8/32 x 5/8** is **"132"**. Put the two together for a part number of **40132**, or simply order by style and size.

Note; When placing your order please ask for Zinc Plated Screws.

Chart #1: Select Styles

Note; Not all Sizes and Styles Available

Style	Slotted	Phillips
Round Head	04	05
Flat Head	02	03
Truss Head	01	n/a
Pan Head	04	n/a
Fillister	06	n/a



Round

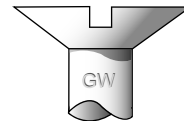

Flat



Truss

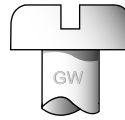

Pan



Fillister

Chart #2: Machine Screw Sizes

	6/32	8/32	10/24	10/32	12/24	1/4 -20	1/4 -28	5/16 -18	5/16 -24	3/8 -16
3/8	104	128	152	153	184	204				
1/2	106	130	154	155	186	206		270		
5/8		132	156	157	188	208	209			
3/4	110	134	158	159	190	210	211	274	275	
7/8		136	160	161	192	212			279	
1	114	138	162	163	194	214	215	280	281	330
1 1/4	116	140	166	167	196	218	219	284	285	334
1 1/2	118	142	168	169	198	220	221	286	287	336
1 3/4			170	171		222		288	289	338
2	122		172	173		224		290	291	340

Machine Screws are sold each



Machine Screw

Chart #3: Sheet Metal Sizes

	#6	#8	#10	#12	#14
1/2	616	628	641	654	667
5/8	617	629	642	655	668
3/4	618	630	643	656	669
1	620	632	645	658	671
1 1/4	621	633	646	659	672
1 1/2	622	634	647	660	673
1 3/4	623	680	648	661	674
2	624	635	649	662	675
2 1/4	625	636	650	663	676
2 1/2	626	637	651	664	677

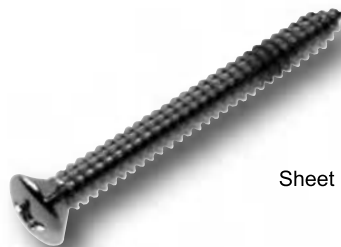

Sheet Metal Screw